

1

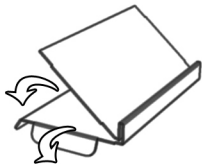

2

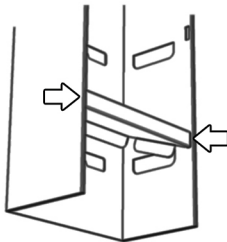

3

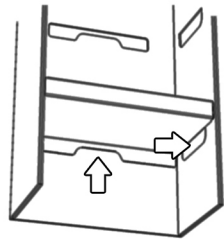

4

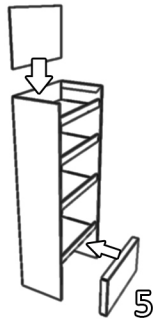

5

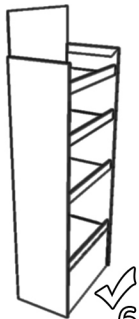

6

1. Fold sides of the stand to a 90 degree angle.
2. Fold the shelves' flaps outwards.
3. Hook the bottom shelf using fastenings.

4. Slid folded shelves's flaps into the cut out areas in the sides of the stand. Back flap should be mounted as shown in the picture.
5. Mount stand base and header.
6. That's all!